

Municipality Of Chatham-Kent

Corporate Services

Municipal Governance

Information Report

To: Mayor and Members of Council

From: Judy Smith, Director, Municipal Governance/Clerk

Date: September 23, 2020

Subject: Storage Shed at Animal Shelter 405 Park Avenue East, Chatham

This report is for the information of Council.

Background

At the May 28, 2018 Council meeting, a Request for Proposal was approved for the building of the new animal shelter at 405 Park Avenue East, Chatham. As the lowest tender came in higher than project budget, the plans and specifications were reviewed in an effort to find cost savings while still maintaining the integrity of programming contents of the building. The building was reduced from the original proposed size of 7,280 sq. ft. size to a 6,200 sq. ft. structure. By reducing the size of the building, it limited the amount of storage space available.

Comments

The Municipality's animal control contractor, Pet and Wildlife Rescue (PAWR) has been utilizing the new shelter since its opening in May of 2019 and enjoying the benefits of this contemporized space. PAWR's contract expires on March 31, 2024 with an option to extend the contract for two additional one-year terms.

PAWR has offered to construct a much needed storage shed at 405 Park Avenue East from its own donated funds to assist with the limited storage space at the new facility. PAWR estimates the total project cost to be approximately \$100,000. Appendix A is a site plan of the location of the storage shed.

The Legal Department has prepared an agreement between the Municipality and PAWR. Although the storage shed will be constructed at no cost to the Municipality, it will be constructed on municipal lands. The agreement ensures that the storage shed remains the property of the Municipality even if we ever discontinue contracting services with PAWR in the future, and sets out the details for maintenance and capital expenditures.

Building Development Services and the Asset Management teams will review the plans and specifications for the proposed storage shed. Any costs for capital expenditures and maintenance of the storage shed would be covered under the lifecycle budget, similar to the new Animal Shelter itself.

Consultation

Legal Services, Building Development Services and Drainage, Asset and Waste Management divisions have been consulted.

Financial Implications

Capital expenditures and future building maintenance investments are required for any new build. It is expected a lifecycle cost of \$4,300 is required on a shed of this size. This amount will be taken from the animal shelter reserve where the 15% of donations from service provider are held and transferred to the building lifecycle reserve annually. In the event that the revenue from donations ever disappeared, a base budget adjustment may be required to fund the lifecycle cost.

Prepared by:

Reviewed by:

Judy Smith, CMO
Director, Municipal Governance/Clerk

Cathy Hoffman, MPA, CHRL
General Manager, Corporate Services/
Chief Human Resource Officer

Consulted and confirmed the content of the consultation section of the report by:

Dave Taylor
Manager Legal Services

Paul Lacina, Chief Building Official

Tim Dick, C.E.T.
Director Drainage, Asset and Waste Management

Appendix A: Site Plan of Shed

p:\rtc\clerk_municipal governance\2020\oct_5 storage shed 405 park ave e,
chatham.docx

Appendix A

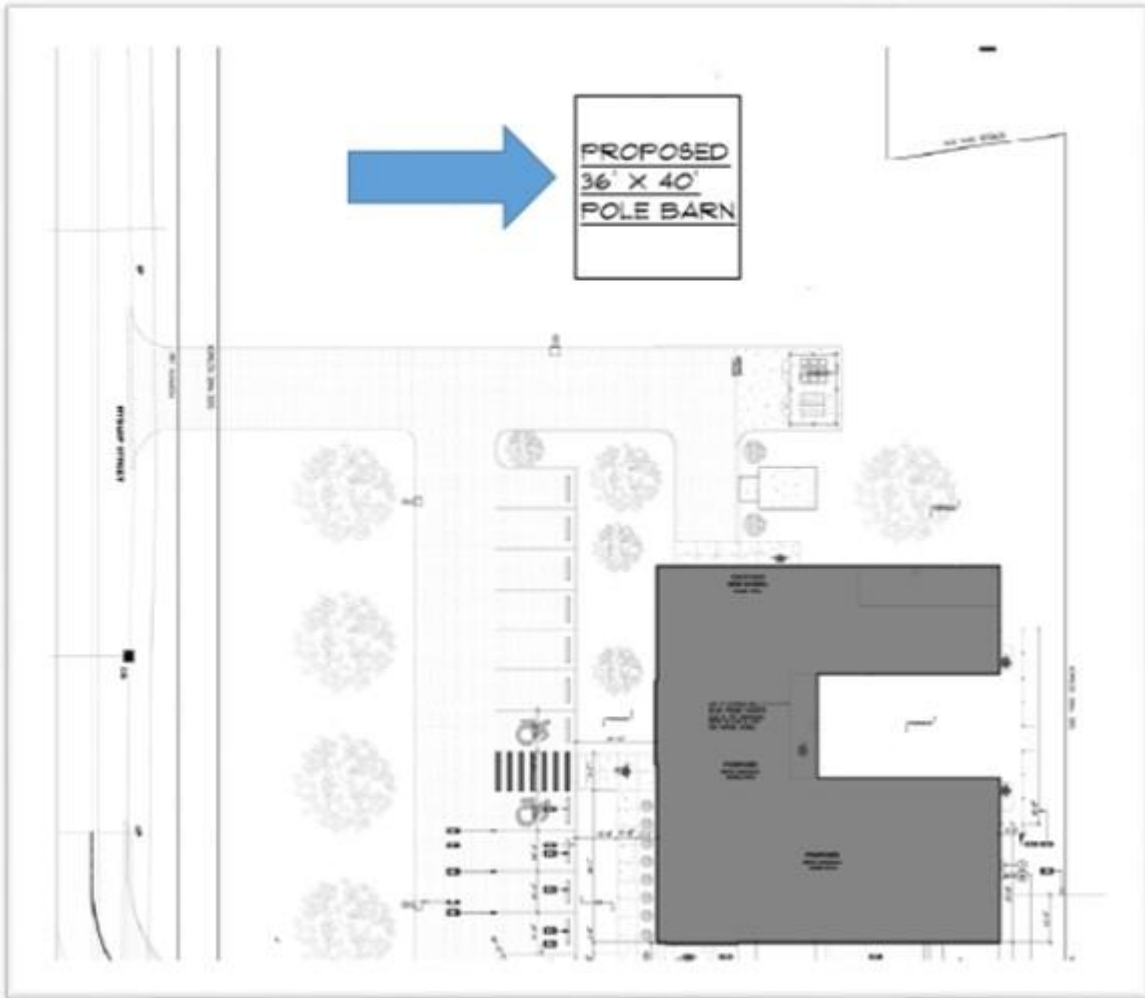

Park Avenue East